

DRAWING OF SONHAT ANICUT SCHEME IN SONHAT RIVER

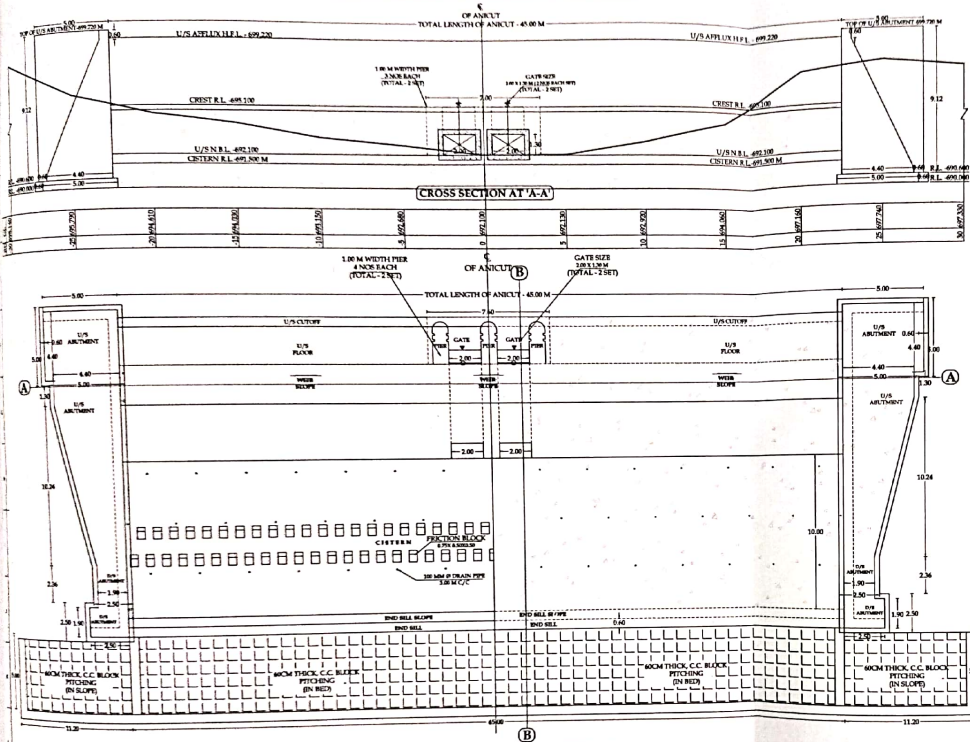

HALF TOP & HALF BOTTOM PLAN
SCALE: 1:1000

NOTES

1. The anicut is to be constructed on the left bank of the river.
2. The approach walls are to be constructed on the right bank of the river.
3. The gates are to be constructed on the left bank of the river.
4. The culverts are to be constructed on the right bank of the river.
5. The embankments are to be constructed on both banks of the river.
6. The slopes of the embankments are to be 1:1.
7. The elevations are to be as shown on the plan.
8. The dimensions are to be as shown on the plan.
9. The materials to be used are to be as specified in the bill of materials.
10. The construction is to be in accordance with the specifications.

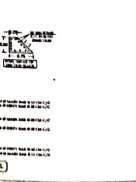
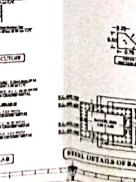
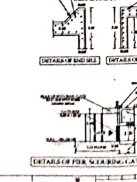
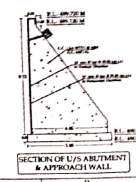

S.NO.	PARTICULARS	DATA	UNITS
1.	CATCHMENT AREA	115.50	Sq.km
2.	BED LEVEL OF RIVER	692.100	M
3.	H.F.L. OF RIVER	694.500	M
4.	LENGTH OF ANICUT	45.00	M
5.	HEIGHT OF ANICUT	3.00	M
6.	TOP OF BANK LEVEL OF RIVER	701.150	M

S.NO.	NAME OF BAR	SIZE	NO. OF BARS	LENGTH OF BAR (M)	TOTAL LENGTH (M)	WEIGHT OF BAR (Kg)	TOTAL WEIGHT (Kg)
BAR BENDING SCHEDULE							
1.	PLATE & WEIR WALL	12	400	22.00	8800	8.800	88000.00
2.	Main Bar	12	300	40.00	12000	12.000	120000.00
3.	Chase Bar	12	300	40.00	12000	12.000	120000.00
4.	APPROACH WALL	12	300	40.00	12000	12.000	120000.00
5.	Main Bar	12	300	40.00	12000	12.000	120000.00
6.	Chase Bar	12	300	40.00	12000	12.000	120000.00
7.	PIER	12	300	40.00	12000	12.000	120000.00
8.	Main Bar	12	300	40.00	12000	12.000	120000.00
9.	Chase Bar	12	300	40.00	12000	12.000	120000.00
10.	Bottom Plate of Gate	12	300	40.00	12000	12.000	120000.00
11.	Main Bar	12	300	40.00	12000	12.000	120000.00
12.	Chase Bar	12	300	40.00	12000	12.000	120000.00
13.	TOP PLATE OF GATE	12	300	40.00	12000	12.000	120000.00
14.	Main Bar	12	300	40.00	12000	12.000	120000.00
15.	Chase Bar	12	300	40.00	12000	12.000	120000.00
16.	WEIR WALL	12	300	40.00	12000	12.000	120000.00
17.	Main Bar	12	300	40.00	12000	12.000	120000.00
18.	Chase Bar	12	300	40.00	12000	12.000	120000.00
19.	UPPER CULVERT & PIER	12	300	40.00	12000	12.000	120000.00
20.	Main Bar	12	300	40.00	12000	12.000	120000.00
21.	Chase Bar	12	300	40.00	12000	12.000	120000.00
22.	FOUNDATION PLATE	12	300	40.00	12000	12.000	120000.00
23.	Main Bar	12	300	40.00	12000	12.000	120000.00
24.	Chase Bar	12	300	40.00	12000	12.000	120000.00
25.	TOP PLATE OF GATE	12	300	40.00	12000	12.000	120000.00
26.	Main Bar	12	300	40.00	12000	12.000	120000.00
27.	Chase Bar	12	300	40.00	12000	12.000	120000.00
28.	WEIR WALL	12	300	40.00	12000	12.000	120000.00
29.	Main Bar	12	300	40.00	12000	12.000	120000.00
30.	Chase Bar	12	300	40.00	12000	12.000	120000.00
31.	UPPER CULVERT & PIER	12	300	40.00	12000	12.000	120000.00
32.	Main Bar	12	300	40.00	12000	12.000	120000.00
33.	Chase Bar	12	300	40.00	12000	12.000	120000.00
34.	FOUNDATION PLATE	12	300	40.00	12000	12.000	120000.00
35.	Main Bar	12	300	40.00	12000	12.000	120000.00
36.	Chase Bar	12	300	40.00	12000	12.000	120000.00
37.	TOP PLATE OF GATE	12	300	40.00	12000	12.000	120000.00
38.	Main Bar	12	300	40.00	12000	12.000	120000.00
39.	Chase Bar	12	300	40.00	12000	12.000	120000.00
40.	WEIR WALL	12	300	40.00	12000	12.000	120000.00
41.	Main Bar	12	300	40.00	12000	12.000	120000.00
42.	Chase Bar	12	300	40.00	12000	12.000	120000.00
43.	UPPER CULVERT & PIER	12	300	40.00	12000	12.000	120000.00
44.	Main Bar	12	300	40.00	12000	12.000	120000.00
45.	Chase Bar	12	300	40.00	12000	12.000	120000.00
46.	FOUNDATION PLATE	12	300	40.00	12000	12.000	120000.00
47.	Main Bar	12	300	40.00	12000	12.000	120000.00
48.	Chase Bar	12	300	40.00	12000	12.000	120000.00
49.	TOP PLATE OF GATE	12	300	40.00	12000	12.000	120000.00
50.	Main Bar	12	300	40.00	12000	12.000	120000.00
51.	Chase Bar	12	300	40.00	12000	12.000	120000.00
52.	WEIR WALL	12	300	40.00	12000	12.000	120000.00
53.	Main Bar	12	300	40.00	12000	12.000	120000.00
54.	Chase Bar	12	300	40.00	12000	12.000	120000.00
55.	UPPER CULVERT & PIER	12	300	40.00	12000	12.000	120000.00
56.	Main Bar	12	300	40.00	12000	12.000	120000.00
57.	Chase Bar	12	300	40.00	12000	12.000	120000.00
58.	FOUNDATION PLATE	12	300	40.00	12000	12.000	120000.00
59.	Main Bar	12	300	40.00	12000	12.000	120000.00
60.	Chase Bar	12	300	40.00	12000	12.000	120000.00
61.	TOP PLATE OF GATE	12	300	40.00	12000	12.000	120000.00
62.	Main Bar	12	300	40.00	12000	12.000	120000.00
63.	Chase Bar	12	300	40.00	12000	12.000	120000.00
64.	WEIR WALL	12	300	40.00	12000	12.000	120000.00
65.	Main Bar	12	300	40.00	12000	12.000	120000.00
66.	Chase Bar	12	300	40.00	12000	12.000	120000.00
67.	UPPER CULVERT & PIER	12	300	40.00	12000	12.000	120000.00
68.	Main Bar	12	300	40.00	12000	12.000	120000.00
69.	Chase Bar	12	300	40.00	12000	12.000	120000.00
70.	FOUNDATION PLATE	12	300	40.00	12000	12.000	120000.00
71.	Main Bar	12	300	40.00	12000	12.000	120000.00
72.	Chase Bar	12	300	40.00	12000	12.000	120000.00
73.	TOP PLATE OF GATE	12	300	40.00	12000	12.000	120000.00
74.	Main Bar	12	300	40.00	12000	12.000	120000.00
75.	Chase Bar	12	300	40.00	12000	12.000	120000.00
76.	WEIR WALL	12	300	40.00	12000	12.000	120000.00
77.	Main Bar	12	300	40.00	12000	12.000	120000.00
78.	Chase Bar	12	300	40.00	12000	12.000	120000.00
79.	UPPER CULVERT & PIER	12	300	40.00	12000	12.000	120000.00
80.	Main Bar	12	300	40.00	12000	12.000	120000.00
81.	Chase Bar	12	300	40.00	12000	12.000	120000.00
82.	FOUNDATION PLATE	12	300	40.00	12000	12.000	120000.00
83.	Main Bar	12	300	40.00	12000	12.000	120000.00
84.	Chase Bar	12	300	40.00	12000	12.000	120000.00
85.	TOP PLATE OF GATE	12	300	40.00	12000	12.000	120000.00
86.	Main Bar	12	300	40.00	12000	12.000	120000.00
87.	Chase Bar	12	300	40.00	12000	12.000	120000.00
88.	WEIR WALL	12	300	40.00	12000	12.000	120000.00
89.	Main Bar	12	300	40.00	12000	12.000	120000.00
90.	Chase Bar	12	300	40.00	12000	12.000	120000.00
91.	UPPER CULVERT & PIER	12	300	40.00	12000	12.000	120000.00
92.	Main Bar	12	300	40.00	12000	12.000	120000.00
93.	Chase Bar	12	300	40.00	12000	12.000	120000.00
94.	FOUNDATION PLATE	12	300	40.00	12000	12.000	120000.00
95.	Main Bar	12	300	40.00	12000	12.000	120000.00
96.	Chase Bar	12	300	40.00	12000	12.000	120000.00
97.	TOP PLATE OF GATE	12	300	40.00	12000	12.000	120000.00
98.	Main Bar	12	300	40.00	12000	12.000	120000.00
99.	Chase Bar	12	300	40.00	12000	12.000	120000.00
100.	WEIR WALL	12	300	40.00	12000	12.000	120000.00

DETAIL OF P. SECTION

DETAIL OF R. SECTION

GOVERNMENT OF CHHATTISGARH WATER RESOURCES DEPARTMENT
OFFICE OF THE EXECUTIVE ENGINEER, W.R. DIVISION, RAJNATHPUR, KOREA (C.G.)
SONHAT ANICUT SCHEME IN HASDEO RIVER

DESIGNER: [Signature]
CHECKED: [Signature]
APPROVED: [Signature]

SCALE: 1:1000
DRAWING NO.: [Number]